

Capital Real Estate Partners, LLC

# AVAILABLE FOR LEASE

## Quality Office / Retail Space



- Aggressive lease rates
- Retail, office uses both possible
- On building and Monument signage
- 4,800 Square feet in total
- Brick façade
- Part of a larger retail complex for good tenant mix amongst retailers
- Abundant parking
- 60' bay depth

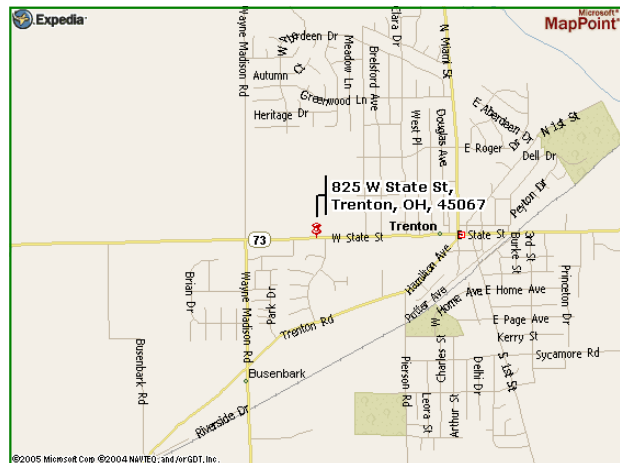

*For further information, please contact:*

**Craig A. Roberts**

(513) 762-7622

craig.roberts@capitalrealestate.org

*Information submitted herein has been obtained from reliable sources. We have no reason to doubt its accuracy, but we do not guarantee it.*



# Site Plan

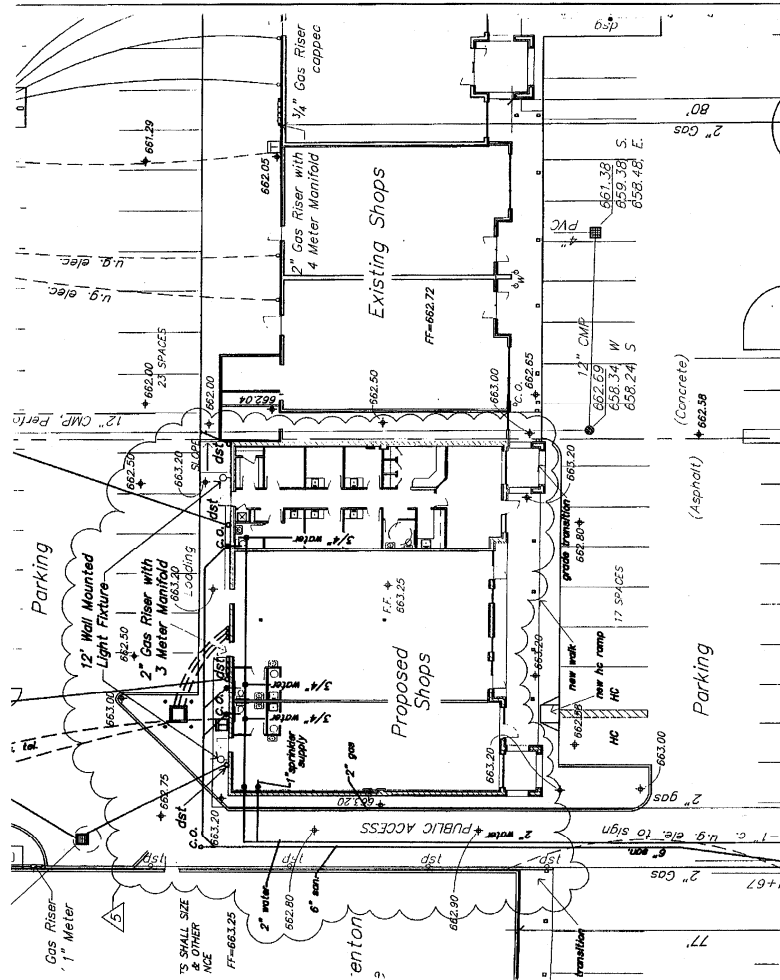

Information submitted herein has been obtained from reliable sources. We have no reason to doubt its accuracy, but we do not guarantee it.